



INTREPID INDUSTRIES INC.

2305 S. Battleground Road
La Porte, TX 77571-9475

T: 281.479.8301
F: 281.479.3453

sales@intrepidindustries.com
www.intrepidindustries.com

TOEBOARD LINKS (T5)



T5-J



T5-L

FEATURES

- Neatly enclose field cut penetrations
- Great for rework
- Eliminates the need to weld banding or split oversize pipe
- Faster on fiberglass grating
- Uniform, finished appearance

INSTALLATION

- No hot work permit required
- No scaffolding required
- Installs from the top-side of grating
- Sandwich grating between hardware and T5
- Easy to install
- Just as fast and easy to remove

WIDESPREAD SUCCESS

- Proven design has been successfully used for over 20 years
- Specified by many multi-national industrial companies
- Recommended & used by many engineering & construction firms

MATERIAL STRENGTH & WEATHERABILITY

- Excellent outdoor weatherability
- In sunlight, material will surface discolor but not degrade
- No loss of tensile strength after 9 months in Arizona and Florida UV-exposure tests

BENEFITS

- Safe & effective
- Maintenance free
- Long service life
- Proven design
- Provides the protection you want
- Economical

CONSTRUCTION

- All molded parts are made from a strong, rigid, UV-resistant polyurethane
- Non-corrosive
- Molded parts colored throughout with safety yellow
- Supplied with galvanized hardware
- 2 Types – J-Bolt (T5-J) or L-Bolt (T5-L)



INTREPID INDUSTRIES INC.

2305 S. Battleground Road
La Porte, TX 77571-9475

T: 281.479.8301
F: 281.479.3453

sales@intrepidindustries.com
www.intrepidindustries.com

T5 LAYOUT & GRATING SPECIFICATION

One Link (T5) To Encircle All Pipe Sizes

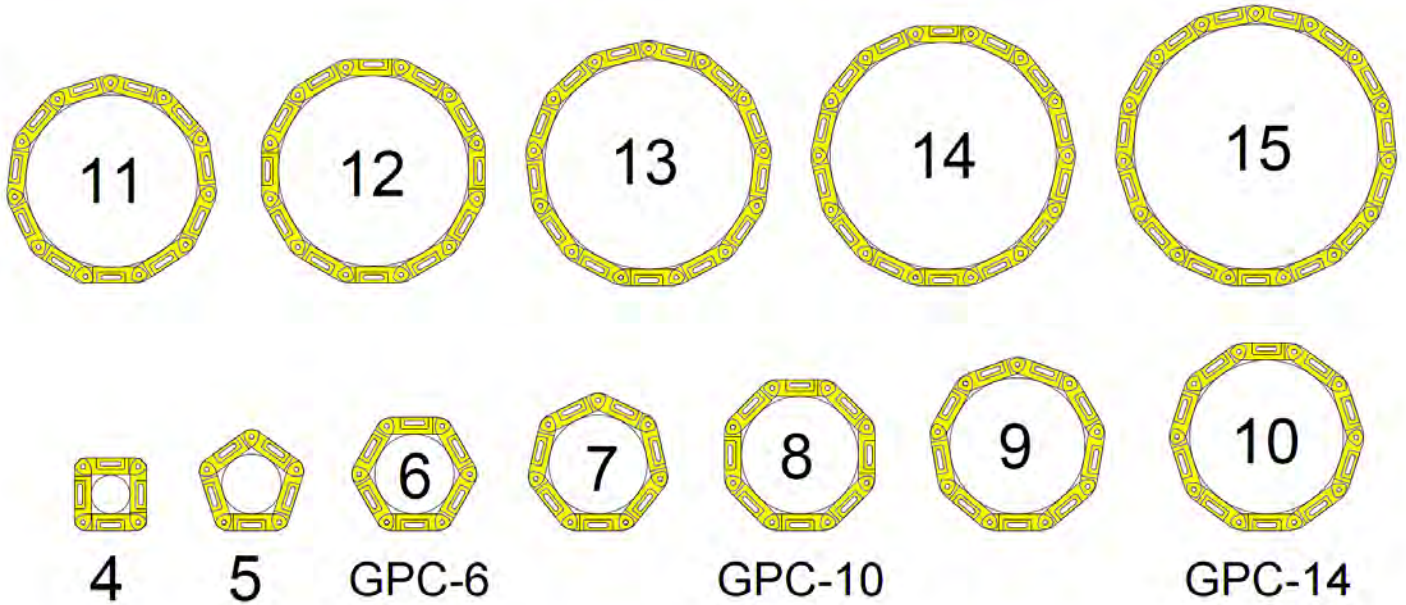

must use on
1 & 2
can use on
3,4,5,or 6

Two Hardware Styles For Most Gratings

must use on
7 & 8
can use on
3,4,5,or 6

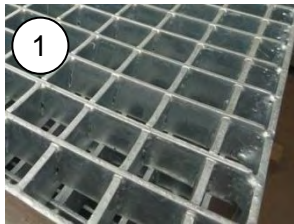

Square Opening

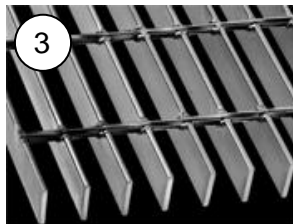

Rectangular Opening

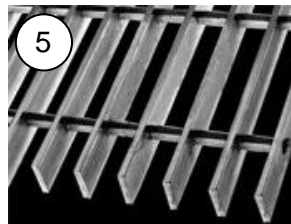

Rectangular Opening

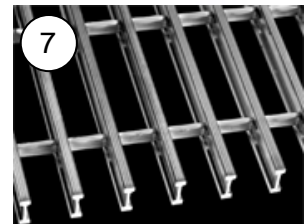

I-bar Rectangular Opening

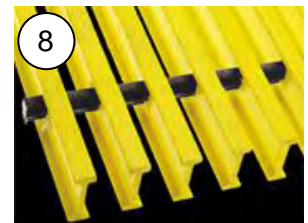
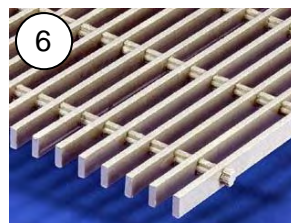
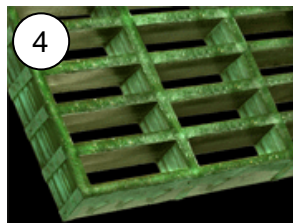
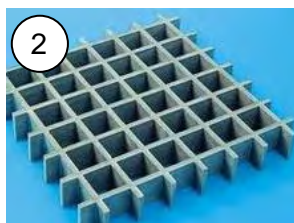

Fast - Easy - Secure - Versatile - No Welding



INTREPID INDUSTRIES INC.

2305 S. Battleground Road
La Porte, TX 77571-9475

T: 281.479.8301
F: 281.479.3453

sales@intrepidindustries.com
www.intrepidindustries.com

T5 DIMENSIONS & LAYOUTS

Number of T5	Max. Inside Circle (Max. Diam.)
4	3.5"
5	5.3"
6	7.1"
7	8.8"
8	10.5"
9	12.2"
10	13.8"
11	15.5"
12	17.1"
13	18.7"
14	20.4"
15	22.0"

To Calculate T5 Links Needed For Larger Circular Enclosures

Round Up
The Result Of

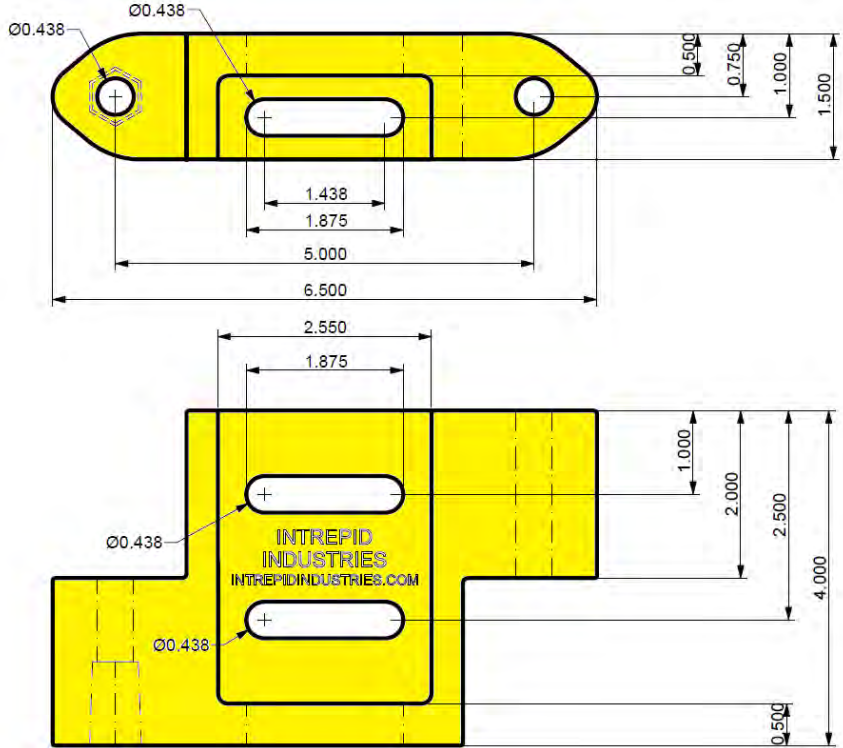
$$\frac{3.2 (\text{Diam.} + 1.6)}{5}$$

10 different ways to use just one box of 10 T5 links

and as corners and couplings with connecting flat plates.

Just think what you can do with a larger box of 40 !



INTREPID INDUSTRIES INC.

2305 S. Battleground Road
La Porte, TX 77571-9475

T: 281.479.8301
F: 281.479.3453

sales@intrepidindustries.com
www.intrepidindustries.com

T5 INSTALLATION

TYPICAL INSTALLATION OF T5-J (J-Bolt) & T5-L (L-Bolt)

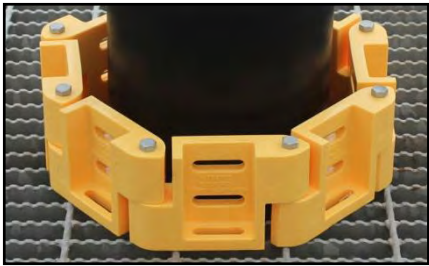

Layout the T5 pieces around the pipe penetration, and insert the 3/8" x 3 1/2" long bolts through the connecting holes. Thread them, but do not tighten.



Drop J/L-bolts in the slots located on the bottom of each T5 piece. Catch one of the grating bars with the J/L-bolt and tighten. Do this for all T5 pieces.

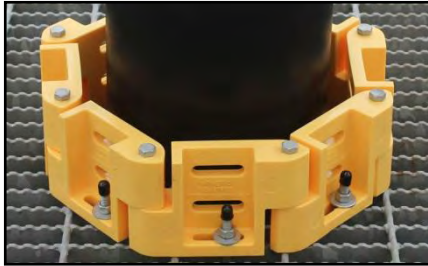

Once all the J/L-bolts are securely fastened, tighten each of the 3/8" x 3 1/2" bolts in the connecting holes.

